

ACTIVE LONG RANGE VGA EXTENTION KIT

ITEM NO.: TTA111VGA



The Active Long Rang Kit allows VGA video signals to be transmitted up to 300 meters via 4-pair CAT5 unshielded twisted pairs cable. Used in pairs, the VGA extender is used in home or commercial applications as a smart, fast and cost-effective, eliminates costly and bulky VGA cable, allowing VGA monitors to be connected extended distances from the PC via standard twisted pair cable. Ideal for classrooms video distribution, lecture halls, retail kiosks, video information displays, overhead projector systems, PC-training systems, and tradeshow PC demo systems.

Features:

- Active type, including transmitter and receiver.
- Built in contrast, brightness adjustment at Receiver.
- Supports up to 1600x1200 @85Hz.
- Built in ESD and power protection.
- LED indication for power and signal.
- Use 4 pairs UTP CAT5 cable instead of VGA cable for long rang transmission.
- Long range transmission up to 300 meters (Max.)

Option model:

VE02DALS VGA & Stereo/Digital Audio CAT5 Receiver– Built in Skew Corrector

- Identical to above TTA111VGAR CAT5 receiver.
- Built in RGB skew adjustment for the optimum video performance under long cable run.
- It could be daisy chained for another VE02DALS to extended working range over 300 meters and multiple displays.

Panel View:

TTA111VGAT

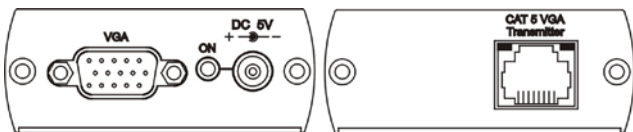

TTA111VGAR

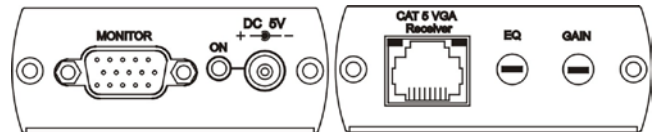

Installation View:

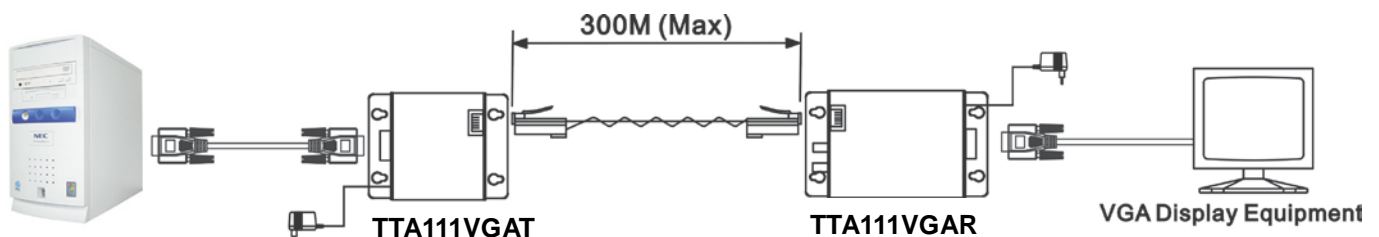

LED Indication

Blue : Power on/off

RJ45 (Link Cable Connector): Green - Signal on/off

Installation Tips:

Skew Picture:

Due to the inside of CAT5 cable that the pairs of wires are twisted at different rates, and the different quality on cable itself and installation that will cause different signal arrival time at each pair. If there are big different at arrival time, that will cause RGB skew status.. This is seen on the monitor as separation, or lack of convergence in colors. Normally it happens on long CAT 5 cable runs.

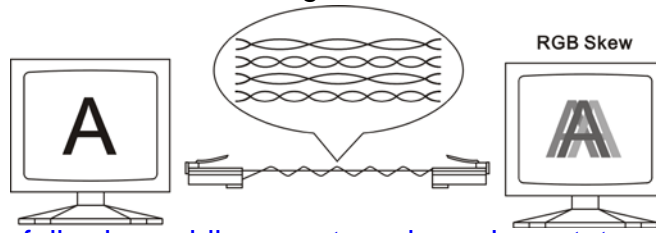

1. Recommend to use following cabling way to reduce skew status, to add special made "skew immunized adaptor", 2 pieces included at the package.

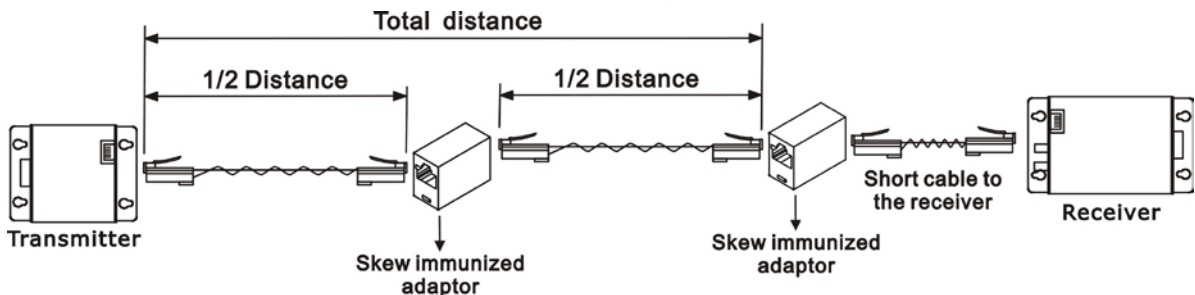

CAUTION: to avoid display equipment damaged, be sure to make correct cable connection and power for both TTA111VGAT, TTA111VGAR before connecting TTA111VGAT, TTA111VGAR.

2. Recommend to change TTA111VGAR CAT5 receiver to VE02DALS, which built in RGB skew adjustment for the optimum video performance under long cable run. It also could be daisy chained for another VE02DALS to extended working range over 300 meters and multiple displays.

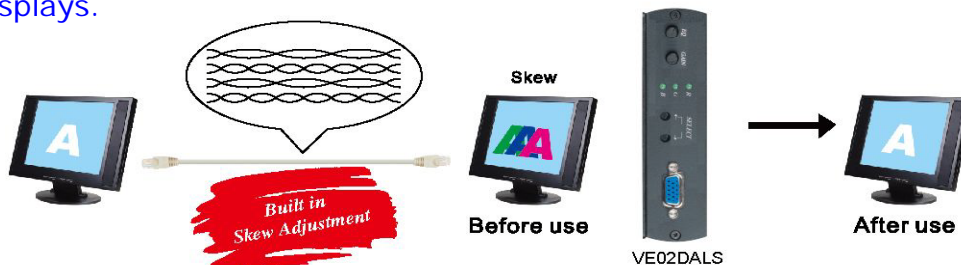

Specification:

ITEM NO.	TTA111VGAT	TTA111VGAR
Support Resolution	Up to 1600 x 1200 @ 85 Hz	
Transmission Distance	Up to 1000 ft. (300 m)	
Video Amplifier Bandwidth	150MHz	
Input Signals	RGB Analog (75Ω, 0.7Vp-p)	
	Sync Signal H/V Separated (TTL)	
Horizontal Frequency Range	30-95KHz	
Vertical Frequency Range	50-180Hz	
VGA Connector	DB15 x 1	
Link Connector	RJ45 x 1	
Power Supply	DC 5V 1Amp	
Power Consumption	150mA (Max)	TTA111VGAR 400mA (Max)
Temperature	Operation: 0 to 55°C, Storage: -20 TO 85°C, Humidity: up to 95%	
Dimensions W x H x D mm	67 x 91 x 27	67 x 110 x 27
Weight g	140	175



Rev.B